

SkidCrete™ - Shipping

Introducing a series of Shipping Container Foundations that are suitable for all Australian conditions and environments. Aus-Precast with Raine Consulting has realised a need in the marketplace for an engineered precast concrete foundation that is ready for immediate use.

Purpose

Provide a structurally designed foundation, with an engineered cast in hoarding, that locks the container in place, coping with the worst load cases arising through AS1170 Structural Actions. This system eradicates the need for external rigging and due to the flush fit finish; thereby removes all external tripping hazards. This offers significant improvements for workplace KPI's.

Design Features

Cast in Hoardings, compatible with static shipping container twist lock systems.
Engineered cast in lifting anchors
Fork tine rebates and heavy-duty concrete mix



Key Customers

Non process and process storage systems.

Mine site camps.

Pop-up Stores (pictured above is only 300mm high) ample room to run cabling and plumbing.

Customised Shipping Container Modifiers.

- Switch Rooms
- Workshops
- Tradeshow Displays
- Restaurants and Cafes





SkidCrete™ - Shipping

Patent 2019100619

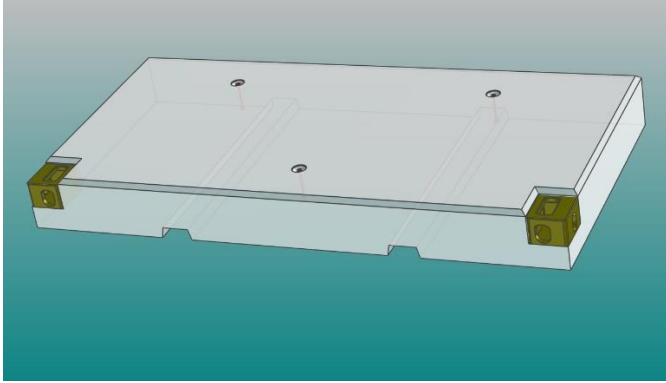

Range

- Type 1 – 2460 W x 600 L x 300 H – Weight 1000kg
- Type 2 – 2460 W x 1200 L x 300 H – Weight 2125kg
- Type 3 – 2460 W x 1200 L x 400 H – Weight 2834kg
- Type 4 – 2460 W x 1200 L x 600 H – Weight 4250kg
- Type 5 – 2460 W x 1800 L x 600 H – Weight 6376kg
- Type 6 – 2460 W x 1800 L x 750 H – Weight 7970kg

Type / Region	A	B	C	D
1	10-20'			
2	40'	10'		
3		20'	10-20'*	
4		20-40'	20-40'*	10-20'*
5		40'	20-40'	20-40'*
6			40'	40'*

***Further calculations may be required and or container grouping is required**

**The above table is a guide only*

Tropical Cyclone

Rating	Wind Speed km/h - m/s	
TC 1	<125 km/h	<34.72
TC 2	125 - 164 km/h	34.72-45.8
TC 3	165 - 224 km/h	45.83-62.5
TC 4	225 - 279 km/h	62.5-77.5
TC 5	>280 km/h	>77.78

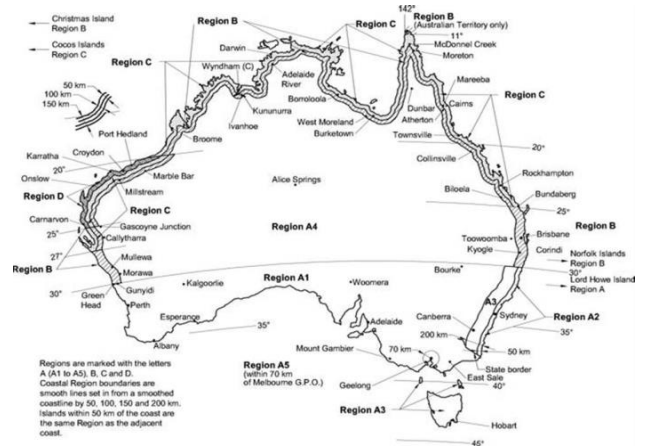

Design working Life 25yrs/Max avg height of 10m			Design Wind Speed (km/h)
AUSTRALIA WIND REGION	ULTIMATE REGIONAL WIND SPEED (KM/H)	IMPORTANCE LEVEL	TERRAIN CATEGORY 2
Region A	162	1	148
		2	155
Region B	205	1	164
		2	178
Region C	248	1	202
		2	219
Region D	316	1	250
		2	273

Contact Us

E: admin@aus-precast.com.au

W: www.aus-precast.com.au

P: **(08) 9523 2555**

