



### **STOp – Solar Traffic Operation**

#### **BOOM GATE**

#### **OUR MISSION**

To inspire companies to choose a healthier, greener option through solar powered equipment. This is the beginning of innovative measures we have undertaken since 2017 by connecting the precast concrete industry with mechanical, electrical and carbon-neutral solar industries. Our aim is to compliment low-site interface requirements utilising the upper end of hazard management within the hierarchy of hazard control, by eliminating, substituting and engineering out.

#### **PURPOSE**

STOp – BOOM GATE is an innovation that removes the requirement of underground power, insitu concrete foundations and reducing risk on-site by reducing man hours through the construction process.

#### **DESIGN FEATURES**

**Stable precast concrete base** – sizes start from 1200mm x 800mm x 300mm in height, all bases come with galvanised fork tine recesses that are centrally positioned, offering positive retention while offloading and moving over uneven ground to their location for installation.



**FAAC B680H** – Automatic 24v Hybrid Barrier, supporting beam lengths from 3 to 8m. The electric over hydraulic motor supports a durable lifespan. The B680H barrier gate operator system consists of an aluminium beam with reflectors and optional lights, a steel upright profile and a metal cover. The operator is mounted on the upright profile and

made with a hydraulic unit and two plunging pistons connected to it by means of a rocker arm, rotate the beam. The beam weight is balanced with a spring fitted on one of the two plunging pistons. The electric control equipment is also housed on the upright profile, inside a transparent plastic compartment. The whole operator is

protected by the external metal cover. The system features an adjustable electronic anti-crushing safety, a device that guarantees stopping and locking of the beam in any position, and a convenient manual release for use in case of power malfunction.



**Mounting Pole / Solar and Control Panel** – Sturdy 80mm NB galvanised post with fabricated base plate. The control panel is powder coated and easy to access for programming and battery maintenance. Solar panel ..... dimensions ..... durability .....

#### **SITE-SPECIFIC DESIGN**

Municipalities – optional EFTrans for unmonitored parks and gardens

Mining Sector – optional light fittings

Security – optional camera

3D modelling for project-specific requirements

#### **LIMITED WARRANTY**

Precast Base – 10 years

FAAC B680H – xx years

Pole – 10 years

Solar Panel – xx years

Battery – xx years

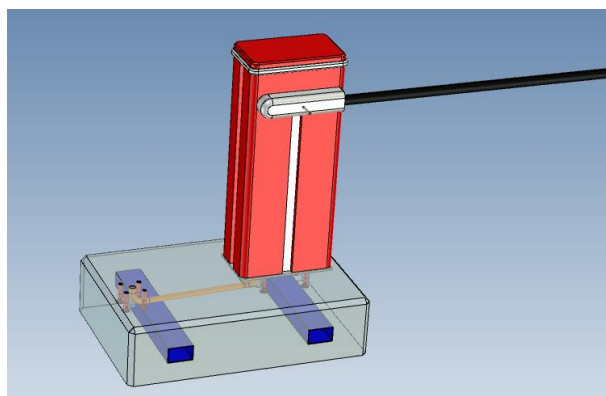

#### **CONTACT US**

E: [admin@aus-precast.com.au](mailto:admin@aus-precast.com.au)

W: [www.aus-precast.com.au](http://www.aus-precast.com.au)

P: (08) 9523 2555